

SPECIALIZED VARIOUS TECHNOLOGY CREATIVE

...
FORGED VALVES

SVT Beyond the valves
CORPORATION

PRODUCT OVERVIEW



SVTC provides a broad range of valves that are available in a wide variety of materials from today's leading valve manufacturers to fully meet even the most complex and unique requirements.

Service that SVTC provides is state-of-the-art technology, on time delivery, multinational staff of trained qualified professionals, world wide sourcing, complete range for blanket agreements.

Our aim is to cater the needs of the customer with adequate support of premier technical and management service, in highly responsible manner.

SVTC has supply chains to provide better and specific requirement of client for wide range of products.



ISO9001



ISO14001



OHSAS18001



API607



API6FA



KS B2361



API600



API602



API6D



API603

FORGED VALVES

- GATE VALVES
- GLOBE VALVES
- CHECK VALVES

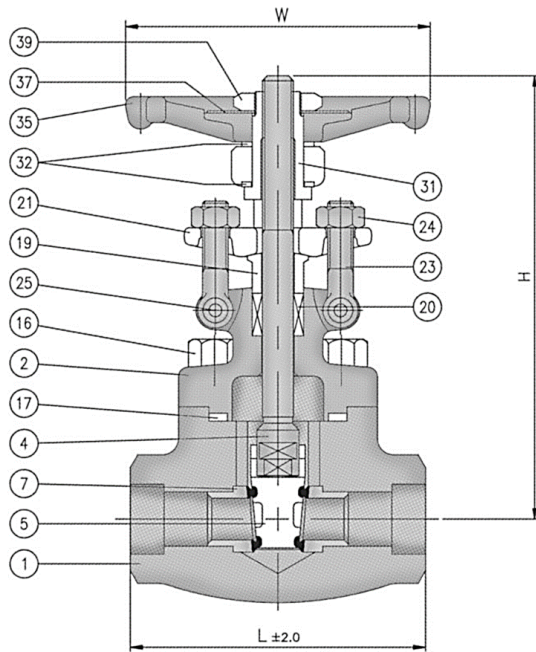

CLASS 600 / 800

VALVE SIZE	in	1/2	3/4	1	1-1/2	2
	mm	15	20	25	40	50
H	in	6.1	6.1	7.6	9.61	11.26
	mm	155	155	193	244	286
W	in	3.93	3.93	4.92	6.1	7.08
	mm	100	100	125	155	180
L	in	3.1	3.62	4.37	5.98	6.77
	mm	79	92	111	152	172
WEIGHT	lb	3.97	4.4	8.38	14.3	22.3
	kg	1.8	2.0	3.8	6.5	10.1

Bolted Bonnet, Out Screw & Yoke, Socketed Welding

Design Code: API 602, ASME B16.34

Socket Weldings Ends: ASME B16.11

STANDARD MATERIAL SPECIFICATION

NO	NAME OF PART	ASTM SPECIFICATION					
		CARBON STEEL	ALLOY STEEL			STAINLESS STEEL	
1	BODY	A105(N)	A182 F11	A182 F22	A182 F91/92	A182 F304	A182 F316
2	BONNET	A105(N)	A182 F11	A182 F22	A182 F91/92	A182 F304	A182 F316
4	STEM	A479-410				A276 T304	A276 T316
5	DISC	*A105	*A182 F11	*A182 F22	*A182 F91/92	A182 F304	A182 F316
7	SEAT RING	*A105	*A182 F11	*A182 F22	*A182 F91/92	A276 T304	A276 T316
16	BONNET BOLT	A193 B7	A193 B16			A193 B8	
17	GASKET	SS304+GRAPHITE					
19	GLAND	A479 410					
20	GLAND PACKING	BRADED GRAPHITE + DIE - FORMED GRAPHITE					
21	GLAND FLANGE	A283-D/A105			A182-F11/F22	A240-304	
23	GLAND BOLT	A193 B8					
24	GLAND NUT	A194-2H	A194-7			A194-8	
25	GLAND BOLT PIN	A576-1020				A276-304	
31	SLEEVE	B62					
32	SLEEVE WASHER	B62					
35	HAND-WHEEL	A536					
37	NAME PLATE	SS304					
39	HAND-WHEEL NUT	A576-1020					

* BASE M'TL+S'TL#6 OVERLAY

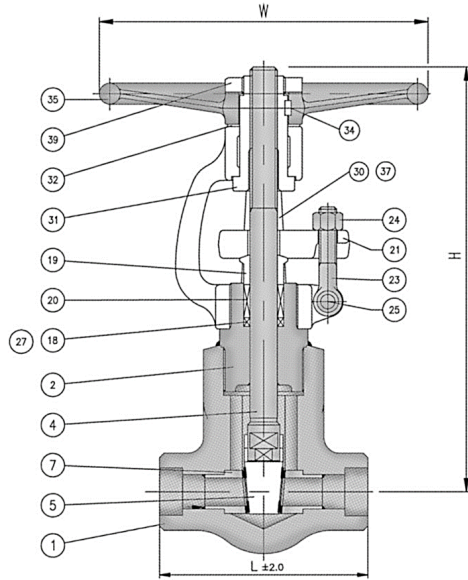

Seal Welded Bonnet, Out Screw & Yoke, Socketed Welding
 Design Code: API 602, ASME B16.34
 Socket Weldings Ends: ASME B16.11

CLASS 900 / 1500

VALVE SIZE	in	1/2	3/4	1	1-1/2	2
	mm	15	20	25	40	50
H	in	9.21	9.21	10.07	12.87	16.93
	mm	234	234	256	327	430
W	in	7.87	7.87	7.87	7.87	9.84
	mm	200	200	200	200	250
L	in	4.33	4.72	5.12	6.29	6.29
	mm	110	120	130	160	200
WEIGHT	lb	13.23	17.64	26.46	39.68	72.75
	kg	6.0	8.0	12.0	18.0	33.0

CLASS 2500

VALVE SIZE	in	1/2	3/4	1	1-1/2	2
	mm	15	20	25	40	50
H	in	13.78	14.49	14.49	20.87	20.87
	mm	368	368	368	530	530
W	in	9.84	9.84	9.84	17.71	17.71
	mm	250	250	250	450	450
L	in	5.91	5.91	5.91	8.26	8.26
	mm	150	150	150	210	210
WEIGHT	lb	44.1	44.1	44.1	176.4	176.4
	kg	20.0	20.0	20.0	80.0	80.0

STANDARD MATERIAL SPECIFICATION

NO	NAME OF PART	ASTM SPECIFICATION					
		CARBON STEEL	ALLOY STEEL			STAINLESS STEEL	
1	BODY	A105(N)	A182 F11	A182 F22	A182 F91/92	A182 F304	A182 F316
2	BONNET	A105(N)	A182 F11	A182 F22	A182 F91/92	A182 F304	A182 F316
4	STEM	A276 431					
5	DISC	*A105(N)	*A182 F11	*A182 F22	*A182 F91	A182 F304	A182 F316
7	SEAT RING	*A105(N)	*A182 F11	*A182 F22	*A182 F91	A276 304	A276 316
18	PACKING WASHER	A479 410				A276 304	A276 316
19	GLAND	A479 410				A276 304	A276 316
20	GLAND PACKING	BRADED GRAPHITE + DIE - FORMED GRAPHITE					
21	GLAND FLANGE	A283-D/A105			A182 F11/F22	A240 304	
23	GLAND BOLT	A193-B7	A193-B16			A193 B8	
24	GLAND NUT	A194-2H	A194-7			A194 8	
25	GLAND BOLT PIN	A276 304					
31	SLEEVE	HIGH-TENSION COPPER ALLOY					
32	SLEEVE WASHER	B62					
35	HAND-WHEEL	A536					
37	NAME PLATE	SS304					
39	HAND-WHEEL NUT	A576-1020					

* BASE M'TL+S'TL#6 OVERLAY

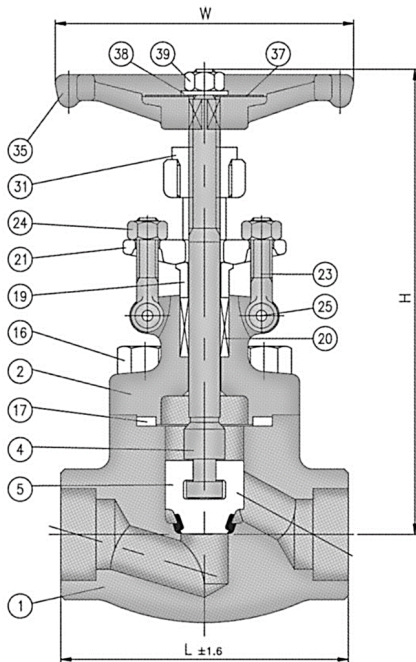

CLASS 600 / 800

VALVE SIZE	in	1/2	3/4	1	1-1/2	2
	mm	15	20	25	40	50
H	in	6.22	6.22	7.76	10.08	10.94
	mm	156	156	197	256	278
W	in	3.93	3.93	4.92	5.11	6.69
	mm	100	100	125	140	170
L	in	3.31	3.62	4.37	5.98	6.77
	mm	79	92	111	152	172
WEIGHT	lb	4.19	4.63	8.38	15.87	24.9
	kg	1.9	2.1	3.8	7.2	11.3

Bolted Bonnet, Out Screw & Yoke, Socketed Welding
 Design Code: API 602, ASME B16.34
 Socket Weldings Ends: ASME B16.11

STANDARD MATERIAL SPECIFICATION

NO	NAME OF PART	ASTM SPECIFICATION					
		CARBON STEEL	ALLOY STEEL			STAINLESS STEEL	
1	BODY	A105(N)	A182 F11	A182 F22	A182 F91/92	A182 F304	A182 F316
2	BONNET	A105(N)	A182 F11	A182 F22	A182 F91/92	A182 F304	A182 F316
4	STEM	A479-410				A276 T304	A276 T316
5	DISC	A743 CA40	A812 F11	A182 F22	A182 F91	A182 F304	A182 F316
16	BONNET BOLT	A193 B7		A193 B16		A193 B8	
17	GASKET	SS304+GRAPHITE					
19	GLAND	A479 410				A276 304	A276 316
20	GLAND PACKING	BRADED GRAPHITE + DIE - FORMED GRAPHITE					
21	GLAND FLANGE	A283-D/A105			A182 F11/F22	A240 304	
23	GLAND BOLT	A193 B8					
24	GLAND NUT	A194-2H	A194-7			A194-8	
25	GLAND BOLT PIN	A276-304					
31	YOKE BUSH	B62					
35	HAND-WHEEL	A536					
37	NAME PLATE	SS304					
38	HAND-WHEEL WASHER	A576-1020					
39	HAND-WHEEL NUT	A194-2H					

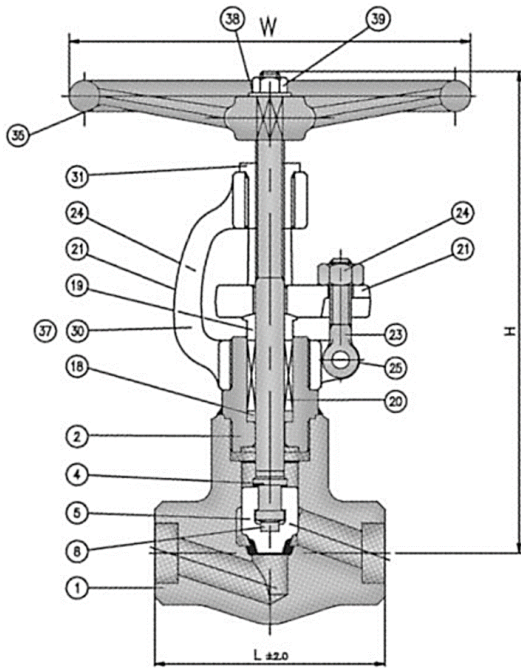

Seal Welded Bonnet, Out Screw & Yoke, Socketed Welding
 Design Code: API 602, ASME B16.34
 Socket Weldings Ends: ASME B16.11

CLASS 900 / 1500

VALVE SIZE	in	1/2	3/4	1	1-1/2	2
	mm	15	20	25	40	50
H	in	10.59	10.59	12.08	17.32	19.13
	mm	269	269	307	440	486
W	in	7.87	7.87	10.23	11.81	16.14
	mm	200	200	260	300	410
L	in	4.72	4.72	5.12	7.87	9.45
	mm	120	120	130	200	240
WEIGHT	lb	7.7	8.8	13.2	33.1	61.7
	kg	3.5	4.0	6.0	15.0	28.0

CLASS 2500

VALVE SIZE	in	1/2	3/4	1	1-1/2	2
	mm	15	20	25	40	50
H	in	10.63	10.63	12.04	17.87	19.65
	mm	270	270	306	454	499
W	in	7.87	7.87	10.23	14.17	16.14
	mm	200	200	260	360	410
L	in	5.11	5.11	5.9	8.66	10.23
	mm	130	130	150	220	260
WEIGHT	lb	8.8	11.0	20.9	55.1	83.8
	kg	4.0	5.0	9.5	25.0	38.0

CLASS 4500

VALVE SIZE	in	1/2	3/4	1	1-1/2	2
	mm	15	20	25	40	50
H	in	12.76	12.76	12.76	18.35	19.65
	mm	324	324	324	466	499
W	in	7.87	7.87	7.87	14.17	16.14
	mm	200	200	200	360	410
L	in	6.30	6.30	6.30	9.84	10.23
	mm	160	160	160	250	260
WEIGHT	lb	37.5	37.5	37.5	110.2	110.2
	kg	17.0	17.0	17.0	50.0	50.0

STANDARD MATERIAL SPECIFICATION

NO	NAME OF PART	ASTM SPECIFICATION					
		CARBON STEEL	ALLOY STEEL			STAINLESS STEEL	
1	BODY	A105(N)	A182 F11	A182 F22	A182 F91/92	A182 F304	A182 F316
2	BONNET	A105(N)	A182 F11	A182 F22	A182 F91/92	A182 F304	A182 F316
4	STEM	A276 431 / A479 431				A276 304	A276 316
5	DISC	A105	A182 F11	A182 F22	A182 F91/92	A182 F304	A182 F316
8	DISC THRUST PLATE	A276-304					
18	PACKING WASHER	A479 410				A276 304	A276 316
19	GLAND	A479 410				A276 304	A276 316
20	GLAND PACKING	GRAPHITE					
21	GLAND FLANGE	A283-D/A105			A182 F11/F22	A240 304	
23	GLAND BOLT	A479-410	A193-B16			A193 B8	
24	GLAND NUT	A194-2H	A194-7			A194 8	
25	GLAND BOLT PIN	A276 304					
30	YOKE	A216 WCB / A105					
31	SLEEVE	A216 WCB/A105	A217 WC6/A182 F11	A217 WC9/A182 F22		A351 CF8/A182 F304	A351 CF8M/A182 F316
35	HAND-WHEEL	A536					
37	NAME PLATE	SS304					
38	HAND-WHEEL WASHER	A576 1020					
39	HAND-WHEEL NUT	A576 1020					

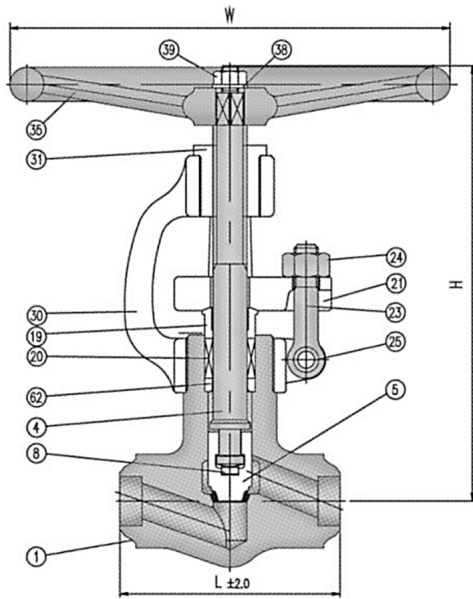

Non Bonnet, Out Screw & Yoke, Socketed Welding
 Design Code: API 602, ASME B16.34
 Socket Weldings Ends: ASME B16.11

CLASS 900 / 1500

VALVE SIZE	in	1/2	3/4	1	1-1/2	2
	mm	15	20	25	40	50
H	in	9.84	9.84	11.02	15.98	17.71
	mm	250	250	280	406	450
W	in	7.87	7.87	10.24	11.81	16.14
	mm	200	200	260	300	410
L	in	4.72	4.72	5.12	7.87	9.45
	mm	120	120	130	200	240
WEIGHT	lb	8.8	8.8	13.2	34.2	60.6
	kg	4.0	4.0	6.0	15.5	27.5

CLASS 2500

VALVE SIZE	in	1/2	3/4	1	1-1/2	2
	mm	15	20	25	40	50
H	in	9.84	9.84	10.94	16.06	17.71
	mm	250	250	278	408	450
W	in	7.87	7.87	10.24	11.81	16.14
	mm	200	200	260	300	410
L	in	5.12	5.12	5.91	8.66	10.24
	mm	130	130	150	220	260
WEIGHT	lb	11.0	19.8	19.8	57.3	86.0
	kg	5.0	5.0	9.0	26.0	39.0

CLASS 4500

VALVE SIZE	in	1/2	3/4	1	1-1/2	2
	mm	15	20	25	40	50
H	in	10.24	10.24	13.38	16.57	16.57
	mm	260	260	340	421	421
W	in	7.87	7.87	10.23	16.14	16.14
	mm	200	200	260	410	410
L	in	5.9	5.9	8.66	10.23	10.23
	mm	150	150	220	260	260
WEIGHT	lb	33.1	33.1	33.1	114.6	114.6
	kg	15.0	15.0	15.0	52.0	52.0

STANDARD MATERIAL SPECIFICATION

NO	NAME OF PART	ASTM SPECIFICATION					
		CARBON STEEL	ALLOY STEEL			STAINLESS STEEL	
1	BODY	A105	A182-F11	A182-F22	A182-F91	A182-F304	F182-F316
4	STEM	A276 431 / A479 431				A276 304	A276 316
5	DISC	A105	A182-F11	A182-F22	A182-F91	A182-F304	F182-F316
8	DISC THRUST PLATE	A276 304					
19	GLAND	A479 410				A276 304	A276 316
20	GLAND PACKING	GRAPHITE					
23	GLAND FLANGE	A283-D/A105			A182 F11/F22	A240 304	
24	GLAND BOLT	A193-B7	A193-B16			A193 B8	
25	GLAND BOLT NUT	A194-2H	A194-7			A194 8	
27	GLAND BOLT PIN	A276 304					
30	YOKE	A216 WCB/A105	A217 WC6/A182 F11	A217 WC9/A182 F22		A351 CF8/A182 F304	A351 CF8M/A182 F316
31	SLEEVE	HIGH-TENSION COPPER ALLOY					
35	HANDWHEEL	A536					
37	NAME PLATE	SS304					
38	HANDWHEEL WASHER	A576 1020					
39	HANDWHEEL NUT	A576 1020					

Y-GLOBE VALVES

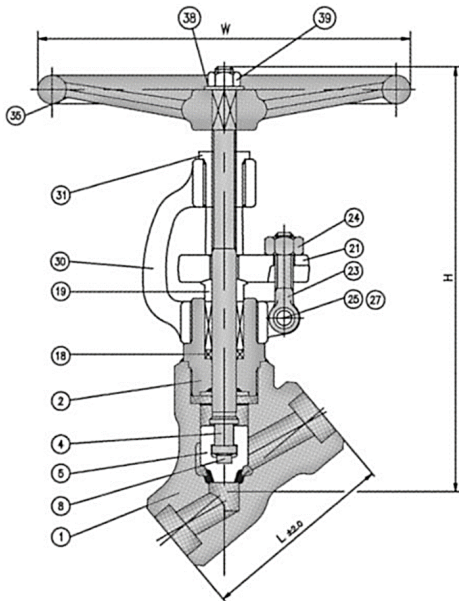

Seal Welded Bonnet, Out Screw & Yoke, Socketed Welding
 Design Code: API 602, ASME B16.34
 Socket Weldings Ends: ASME B16.11

CLASS 900 / 1500

VALVE SIZE	in	1/2	3/4	1	1-1/2	2
	mm	15	20	25	40	50
H	in	7.4	7.4	8.38	12	13.22
	mm	188	188	213	305	336
W	in	7.87	7.87	10.23	11.81	16.14
	mm	200	200	260	300	410
L	in	5.11	5.11	5.9	7.87	9.45
	mm	130	130	150	200	240
WEIGHT	lb	7.7	8.8	13.2	33.1	61.7
	kg	3.5	4.0	6.0	15.0	28.0

CLASS 2500

VALVE SIZE	in	1/2	3/4	1	1-1/2	2
	mm	15	20	25	40	50
H	in	7.44	7.44	8.38	12.36	13.54
	mm	189	189	213	314	344
W	in	9.84	9.84	10.24	11.81	16.14
	mm	250	250	260	300	410
L	in	5.11	5.11	5.91	8.66	10.24
	mm	130	130	150	220	260
WEIGHT	lb	8.8	11.0	20.9	55.1	83.8
	kg	4.0	5.0	9.5	25.0	38.0

CLASS 4500

VALVE SIZE	in	1/2	3/4	1	1-1/2	2
	mm	15	20	25	40	50
H	in	12.95	12.95	12.95	18.82	18.82
	mm	329	329	329	478	478
W	in	7.87	7.87	7.87	14.17	16.14
	mm	200	200	200	360	410
L	in	6.69	6.69	6.69	10.24	10.24
	mm	170	170	170	260	260
WEIGHT	lb	37.5	37.5	37.5	110.2	110.2
	kg	17.0	17.0	17.0	50.0	50.0

STANDARD MATERIAL SPECIFICATION

NO	NAME OF PART	ASTM SPECIFICATION					
		CARBON STEEL	ALLOY STEEL			STAINLESS STEEL	
1	BODY	A105(N)	A182 F11	A182 F22	A182 F91/92	A182 F304	A182 F316
2	BONNET	A105(N)	A182 F11	A182 F22	A182 F91/92	A182 F304	A182 F316
4	STEM	A276 431 / A479 431				A276 304	A276 316
5	DISC	A105	A182 F11	A182 F22	A182 F91/92	A182 F304	A182 F316
8	DISC THRUST PLATE	A276 304					
18	PACKING WASHER	A479 410				A276 304	A276 316
19	GLAND	A479 410				A276 304	A276 316
20	GLAND PACKING	GRAPHITE					
21	GLAND FLANGE	A283-D/A105			A182 F11/F22	A240 304	
23	GLAND BOLT	A193-B7	A193-B16			A193 B8	
24	GLAND NUT	A194-2H	A194-7			A194 8	
25	GLAND BOLT PIN	A276 304					
30	YOKE	A216 WCB/A105	A217 WC6/A182 F11	A217 WC9/A182 F22		A351 CF8/A182 F304	A351 CF8M/A182 F316
31	SLEEVE	HIGH-THNSION COPPER ALLOY					
35	HAND-WHEEL	A536					
37	NAME PLATE	SS304					
38	HAND-WHEEL WASHER	A576 1020					
39	HAND-WHEEL NUT	A576 1020					
42	TAG PLATE	SS304					

LIFT CHECK VALVES

- ▶ BOLTED BONNET
- ▶ SEAL WELDED COVER

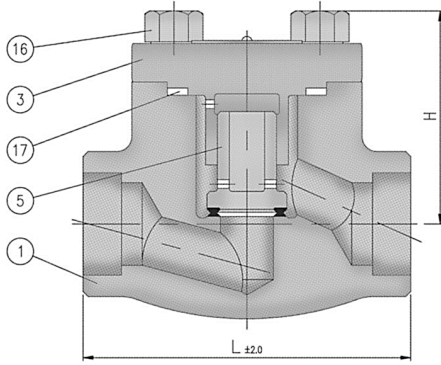

Bolted Cover (CLASS 600 / 800)

CLASS 600 / 800

VALVE SIZE	in	1/2	3/4	1	1-1/2	2
	mm	15	20	25	40	50
H	in	2.46	2.46	2.46	3.22	4.25
	mm	63	63	63	82	108
L	in	4.37	4.37	4.4	5.98	6.77
	mm	111	111	111	152	172
WEIGHT	lb	2.65	3.09	5.73	12.1	19.8
	kg	1.2	1.4	2.6	5.5	9.0

Design Code: API 602, ASME B16.34

Socket Weldings Ends: ASME B16.11

STANDARD MATERIAL SPECIFICATION

NO	NAME OF PART	ASTM SPECIFICATION (CLASS 600 / 800)					
		CARBON STEEL	ALLOY STEEL			STAINLESS STEEL	
1	BODY	A105(N)	A182 F11	A182 F22	A182 F91/92	A182 F304	A182 F316
2	COVER	A105(N)	A182 F11	A182 F22	A182 F91/92	A182 F304	A182 F316
5	DISC	A276 410				A276 304	A276 316
16	COVER BOLT	A193 B7			A193 B16	A193 B8	
17	GASKET	SS304 + GRAPHITE					
37	NAME PLATE	SS304					

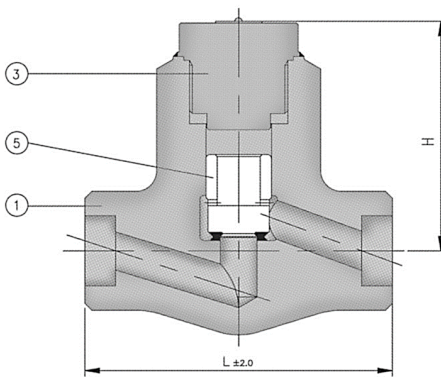

Seal Welded Cover (CLASS 900/1500/2500/4500)

CLASS 2500

VALVE SIZE	in	1/2	3/4	1	1-1/2	2
	mm	15	20	25	40	50
H	in	5.94	5.94	5.94	7.64	8.66
	mm	151	151	151	194	220
L	in	5.9	5.9	5.91	8.66	10.24
	mm	150	150	150	220	260
WEIGHT	lb	6.6	8.8	14.3	37.5	57.3
	kg	3.0	4.0	6.5	17.0	26.0

CLASS 900 / 1500

VALVE SIZE	in	1/2	3/4	1	1-1/2	2
	mm	15	20	25	40	50
H	in	5.94	5.94	5.94	7.36	8.07
	mm	151	151	151	187	205
L	in	5.11	5.11	5.12	7.87	9.45
	mm	130	130	130	200	240
WEIGHT	lb	4.4	6.6	9.9	24.3	43.0
	kg	2.0	3.0	4.2	11.0	19.5

CLASS 4500

VALVE SIZE	in	1/2	3/4	1	1-1/2	2
	mm	15	20	25	40	50
H	in	6.45	6.45	6.45	8.34	8.34
	mm	164	164	164	212	212
L	in	8.66	8.66	8.66	10.23	10.23
	mm	220	220	220	260	260
WEIGHT	lb	28.7	28.7	28.7	86.0	86.0
	kg	13.0	13.0	13.0	39.0	39.0

NO	NAME OF PART	ASTM SPECIFICATION (CLASS 900/1500/2500/4500)					
		CARBON STEEL	ALLOY STEEL			STAINLESS STEEL	
1	BODY	A105(N)	A182 F11	A182 F22	A182 F91/92	A182 F304	A182 F316
2	COVER	A105(N)	A182 F11	A182 F22	A182 F91/92	A182 F304	A182 F316
5	DISC	A105(N)	A182 F11	A182 F22	A182 F91/92	A182 F304	A182 F316
37	NAME PLATE	SS304					

SWING CHECK VALVES

- ▶ BOLTED BONNET
- ▶ SEAL WELDED COVER

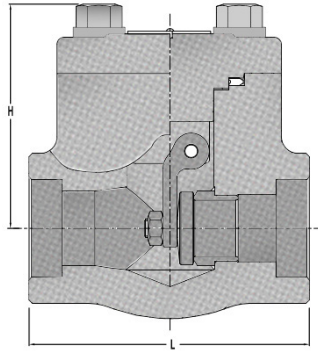

Bolted Cover (CLASS 600 / 800)

CLASS 600 / 800

VALVE SIZE	in	1/2	3/4	1	1-1/2	2
	mm	15	20	25	40	50
H	in	202	202	2.83	3.9	4.57
	mm	56	56	72	99	116
L	in	3.1	3.6	4.4	5.98	6.77
	mm	79	92	111	152	172
WEIGHT	lb	2.65	3.09	5.73	12.1	19.8
	kg	1.2	1.4	2.6	5.5	9.0

Design Code: API 602, ASME B16.34

Socket Weldings Ends: ASME B16.11

STANDARD MATERIAL SPECIFICATION

NO	NAME OF PART	ASTM SPECIFICATION (CLASS 600 / 800)					
		CARBON STEEL	ALLOY STEEL			STAINLESS STEEL	
1	BODY	A105(N)	A182 F11	A182 F22	A182 F91/92	A182 F304	A182 F316
2	COVER	A105(N)	A182 F11	A182 F22	A182 F91/92	A182 F304	A182 F316
5	DISC	A276 410				A276 304	A276 316
16	COVER BOLT	A193 B7			A193 B16	A193 B8	
17	GASKET	SS304 + GRAPHITE					
37	NAME PLATE	SS304					

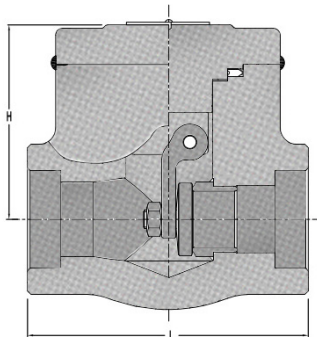

Seal Welded Cover (CLASS 900/1500/2500/4500)

CLASS 2500

VALVE SIZE	in	1/2	3/4	1	1-1/2	2
	mm	15	20	25	40	50
H	in	3.11	3.78	4.49	5.94	6.61
	mm	79	96	114	151	168
L	in	4.53	5.12	5.91	8.66	10.24
	mm	115	130	150	220	260
WEIGHT	lb	6.6	8.8	14.3	37.5	57.3
	kg	3.0	4.0	6.5	17.0	26.0

CLASS 900 / 1500

VALVE SIZE	in	1/2	3/4	1	1-1/2	2
	mm	15	20	25	40	50
H	in	2.83	3.15	3.74	5.08	6.06
	mm	72	80	95	129	154
L	in	4.33	4.72	5.12	7.87	9.45
	mm	110	120	130	200	240
WEIGHT	lb	4.4	6.6	9.9	24.3	43.0
	kg	2.0	3.0	4.2	11.0	19.5

CLASS 4500

VALVE SIZE	in	1/2	3/4	1	1-1/2	2
	mm	15	20	25	40	50
H	in	4.84	4.84	4.84	7.05	7.05
	mm	123	123	123	179	179
L	in	6.30	6.30	6.30	9.84	9.84
	mm	160	160	160	250	250
WEIGHT	lb	28.7	28.7	28.7	86.0	86.0
	kg	13.0	13.0	13.0	39.0	39.0

NO	NAME OF PART	ASTM SPECIFICATION (CLASS 900/1500/2500/4500)					
		CARBON STEEL	ALLOY STEEL			STAINLESS STEEL	
1	BODY	A105(N)	A182 F11	A182 F22	A182 F91/92	A182 F304	A182 F316
2	COVER	A105(N)	A182 F11	A182 F22	A182 F91/92	A182 F304	A182 F316
5	DISC	A105(N)	A182 F11	A182 F22	A182 F91/92	A182 F304	A182 F316
37	NAME PLATE	SS304					

Y-CHECK VALVES

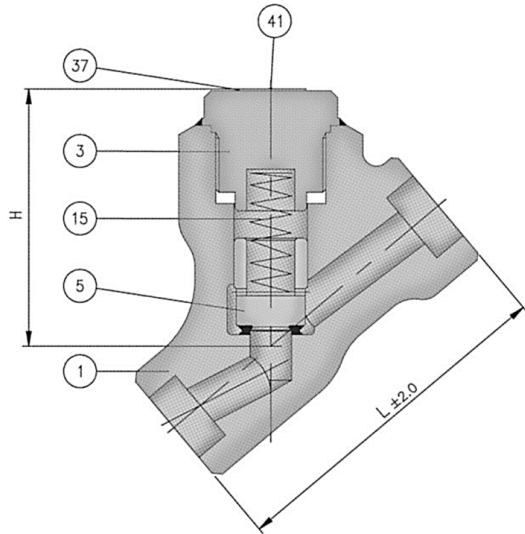

Seal Welded Bonnet, Out Screw & Yoke, Socketed Welding
 Design Code: API 602, ASME B16.34
 Socket Weldings Ends: ASME B16.11

CLASS 900 / 1500

VALVE SIZE	in	1/2	3/4	1	1-1/2	2
	mm	15	20	25	40	50
H	in	5.07	5.07	5.07	5.86	7.28
	mm	129	129	129	149	185
L	in	5.91	5.91	5.91	7.87	9.45
	mm	150	150	150	200	240
WEIGHT	lb	4.4	6.6	9.9	24.3	43.0
	kg	2.0	3.0	4.5	11.0	19.5

CLASS 2500

VALVE SIZE	in	1/2	3/4	1	1-1/2	2
	mm	15	20	25	40	50
H	in	5.07	5.07	5.07	5.94	6.81
	mm	129	129	129	151	173
L	in	5.91	5.91	5.91	8.66	10.24
	mm	150	150	150	220	260
WEIGHT	lb	6.6	8.8	14.3	37.5	57.3
	kg	3.0	4.0	6.5	17.0	26.0

CLASS 4500

VALVE SIZE	in	1/2	3/4	1	1-1/2	2
	mm	15	20	25	40	50
H	in	5.16	5.16	5.16	7.68	7.68
	mm	131	131	131	195	195
L	in	6.69	6.69	6.69	10.24	10.24
	mm	170	170	170	260	260
WEIGHT	lb	28.7	28.7	28.7	86.0	86.0
	kg	13.0	13.0	13.0	39.0	39.0

STANDARD MATERIAL SPECIFICATION

NO	NAME OF PART	ASTM SPECIFICATION (CLASS 900/1500/2500/4500)					
		CARBON STEEL	ALLOY STEEL			STAINLESS STEEL	
1	BODY	A105(N)	A182 F11	A182 F22	A182 F91/92	A182 F304	A182 F316
2	COVER	A105(N)	A182 F11	A182 F22	A182 F91/92	A182 F304	A182 F316
5	DISC	A105(N)	A182 F11	A182 F22	A182 F91/92	A182 F304	A182 F316
37	NAME PLATE	SS304					

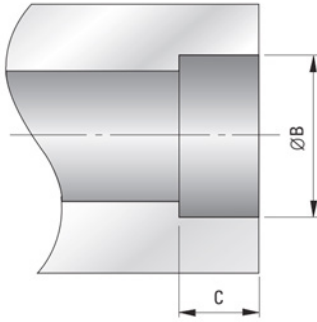

SOCKET WELDING

Valve Size		ASME B16.11						KS B1542 / JIS B 2316					
		$\varnothing B$				Min. C		$\varnothing B$				Min. C	
		Min.		Max.				Min.		Max.			
DN	in	mm	in	mm	in	mm	in	mm	in	mm	in	mm	in
15	1/2	21.8	0.858	22.2	0.874	9.5	0.38	22.2	0.87	22.5	0.89	10	0.38
20	3/4	27.2	1.07	27.6	1.086	12.5	0.5	27.7	1.09	28	1.1	13	0.5
25	1	33.9	1.334	34.3	1.35	12.5	0.5	34.5	1.36	34.8	1.37	13	0.5
32	1 1/4	42.7	1.681	43.1	1.696	12.5	0.5	43.2	1.7	43.5	1.71	13	0.5
40	1 1/2	48.8	1.921	49.2	1.937	12.5	0.5	49.1	1.93	49.4	1.94	13	0.5
50	2	61.2	2.409	61.7	2.429	16	0.62	61.1	2.41	61.4	2.42	16	0.62

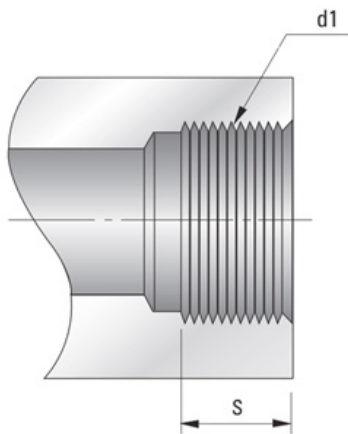

THREADED

Valve Size		ASME B 16.11 / B1. 20.1				KS B0222 / JIS B 0203			
		Thread, Min. S		Thread, d1	Thread, Min. S		Thread, d1		
		DN	in		DN	in			
15	1/2	10.9	0.43	1/2 - 12NPT	12.7	0.5	PT1/2-14		
20	3/4	12.7	0.5	3/4 - 10NPT	14.1	0.56	PT3/4-14		
25	1	14.7	0.58	1 - 8NPT	16.2	0.64	PT1-11		
32	1 1/4	17	0.67	1 1/4 - 7NPT	18.5	0.73	PT1 1/4-11		
40	1 1/2	17.8	0.7	1 1/2 - 6NPT	18.5	0.73	PT1 1/2-11		
50	2	19	0.75	2 - 4.5NPT	22.8	0.9	PT2-11		

FLANGED END DIMENSIONS



CLASS 10K, 20K, 40K CLASS 150, 300

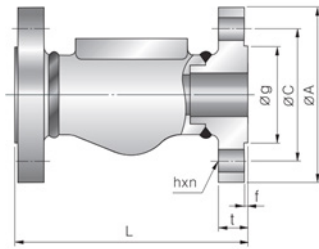

SOCKET WELDING + FLANGE

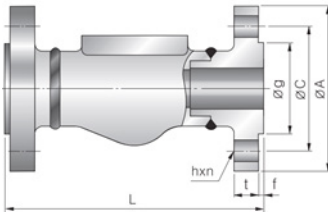

SOCKET WELDING + FLANGE

FLANGE TYPE DIMENSIONS JIS B2002 / B2220										
CLASS	SIZE	GATE	GLOBE	CHECK	ØA	ØC	hxn	Øg	f	t
		L								
10K	15A 1/2"	165	165	165	95	70	15x4	51	1	12
	20A 3/4"	190	190	190	100	75	15x4	56	1	14
	25A 1"	216	216	216	125	90	19x4	67	1	14
	32A 1-1/4"	229	229	229	135	100	19x4	76	2	16
	40A 1-1/2"	241	241	241	140	105	19x4	81	2	16
20K	15A 1/2"	165	165	165	95	70	15x4	51	1	14
	20A 3/4"	190	190	190	100	75	15x4	56	1	16
	25A 1"	216	216	216	125	90	19x4	67	1	16
	32A 1-1/4"	229	229	229	135	100	19x4	76	2	18
	40A 1-1/2"	241	241	241	140	105	19x4	81	2	18
40K	15A 1/2"	165	165	165	115	80	19x4	55	1	20
	20A 3/4"	190	190	190	120	85	19x4	60	1	20
	25A 1"	216	216	216	130	95	19x4	70	1	22
	32A 1-1/4"	229	229	229	140	105	19x4	80	2	24
	40A 1-1/2"	241	241	241	160	120	23x4	90	2	24
63K	15A 1/2"	216	216	216	120	85	19x4	55	1	23
	20A 3/4"	229	229	229	135	95	23x4	60	1	25
	25A 1"	254	254	254	140	100	23x4	70	1	27
	32A 1-1/4"	279	279	279	150	110	23x4	80	2	30
	40A 1-1/2"	305	305	305	175	130	25x4	90	2	32
	50A 2"	368	368	368	185	145	23x8	105	2	34

FLANGE TYPE DIMENSIONS ASME B16.10 / B16.5										
CLASS	SIZE	GATE	GLOBE	CHECK	ØA	ØC	hxn	Øg	f	t
		L								
150	15A 1/2"	165	165	165	90	60.3	15.9x4	34.9	2	8
	20A 3/4"	190	190	190	100	69.9	15.9x4	42.9	2	8.9
	25A 1"	216	216	216	110	79.4	15.9x4	50.8	2	9.6
	32A 1-1/4"	229	229	229	115	88.9	15.9x4	63.5	2	11.2
	40A 1-1/2"	241	241	241	125	98.4	15.9x4	73	2	12.7
300	15A 1/2"	292	292	292	150	120.7	19.1x4	92.1	2	14.3
	20A 3/4"	165	165	165	95	66.7	15.9x4	34.9	2	12.7
	25A 1"	190	190	190	115	82.6	19.1x4	42.9	2	14.3
	32A 1-1/4"	216	216	216	125	88.9	19.1x4	50.8	2	15.9
	40A 1-1/2"	229	229	229	135	98.4	19.1x4	63.5	2	17.5
	50A 2"	241	241	241	155	114.3	22.2x4	73	2	19.1
		292	292	292	165	127	19.1x8	92.1	2	20.7

FLANGE TYPE DIMENSIONS ASME B16.10 / B16.5										
CLASS	SIZE	L			ØA	ØC	hxn	Øg	f	t
		GATE	GLOBE	CHECK						
600	15A 1/2"	165	165	165	95	66.7	15.9x4	34.9	7	14.3
	20A 3/4"	190	190	190	115	82.6	19.1x4	42.9	7	15.9
	25A 1"	216	216	216	125	88.9	19.1x4	50.8	7	17.5
	32A 1-1/4"	229	229	229	135	98.4	19.1x4	63.5	7	20.7
	40A 1-1/2"	241	241	241	155	114.3	22.2x4	73	7	22.3
1500	15A 1/2"	292	292	292	165	127	19.1x8	92.1	7	25.4
	20A 3/4"	216	216	216	120	82.6	22.2x4	34.9	7	22.3
	25A 1"	229	229	229	130	88.9	22.2x4	42.9	7	25.4
	32A 1-1/4"	254	254	254	150	101.6	25.4x4	50.8	7	28.6
	40A 1-1/2"	279	279	279	160	111.1	25.4x4	63.5	7	28.6
2500	15A 1/2"	305	305	305	180	123.8	28.6x4	73	7	31.8
	20A 3/4"	368	368	368	215	165.1	25.4x8	92.1	7	38.1
	25A 1"	264	264	264	135	88.9	22.2x4	34.9	7	30.2
	32A 1-1/4"	273	273	273	140	95.2	22.2x4	42.9	7	31.8
	40A 1-1/2"	308	308	308	160	108	25.4x4	50.8	7	35.0
	50A 2"	349	349	349	185	130.2	28.6x4	63.5	7	38.1
		384	384	384	205	146	31.8x4	73	7	44.5
		451	451	451	235	171.4	28.6x8	92.1	7	50.9

The gate valve is normally supplied with a flexible wedge, on request with solid wedge, parallel slides with spring. All the wedges are fully guided

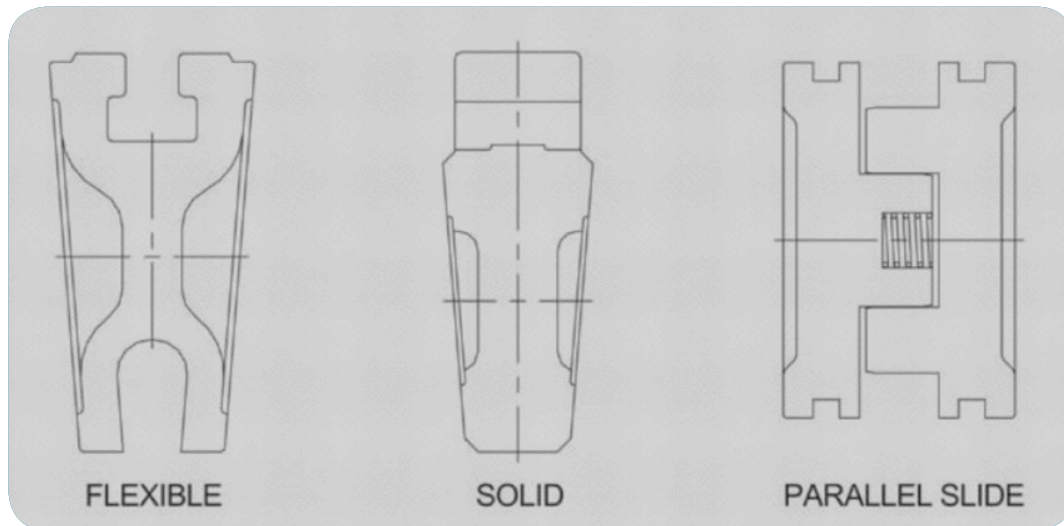

The globe valve is normally supplied with plug type disc. Parabolic discs and equilibrated discs. Equilibrated discs are normally supplied when differential pressure is very high and the service is on-off. In this case the flow direction is over the disc.

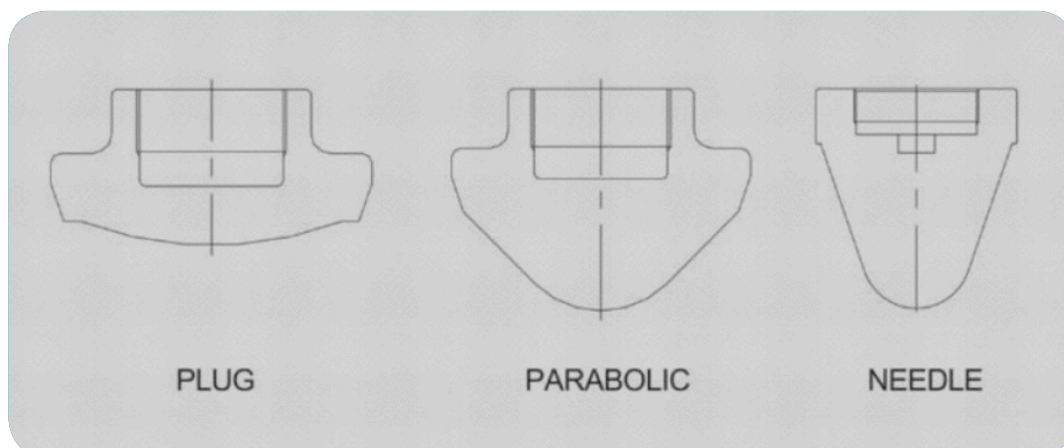

■ Bevel Gear Actuator

Auxiliary gearing is often desirable to facilitate the operation of large size valves required to close against high pressure.

SVT Valves can be furnished with a fully enclosed light weight and maintenance free bevel gear actuators.

Inquiries of order for valves with gear actuators should include the following information :

- Size and figure number of valve
- Service media, pressure and temperature
- Maximum pressure against which valve must close
- Desired orientation of handwheel to stem
- Desired orientation of handwheel to pipe run
- Limitations, if, any, on the types or brand of actuator

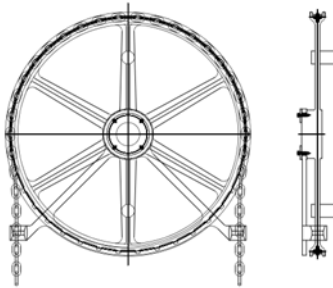
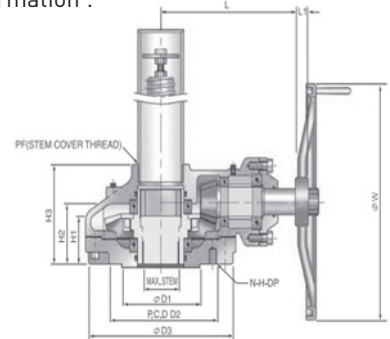

■ Chainwheels

Chainwheels can be furnished complete with chainwheel and chain guide. They are means of safe and convenient floor operation of valves in overhead of inaccessible locations.

■ Electric Motor Actuators

Electric Moto Actuators are available for valves which are in accessibly located, or where emergency may require rapid, positive operation from a remote point.

SVT Valves can supplies electric motor actuators for each type of SVT Valves when required.

Show on this page are examples of various available actuators.

Inquires or orders for electric motor actuated valves should include the following information:

- Size and figure number of valve
- Service media, pressure and temperature
- Maximum pressure against which valve must close
- Desired stem speed or closing time
- Frequency of operation
- Electric power available (voltage, frequency & phases)
- NEMA type of electrical enclosure
- Reversing controller specifications
- Control station specifications
- Accessories (Position indicator, dial position indicator, etc.)



■ Bypasses

Bypasses are used in steam service for warning up before the main line is opened, and for balancing pressures where the lines are of limited volume. All welded bypasses for SVT Valves can be furnished with drop forged steel OS&Y globe valves

when specified.

Bypass unit has a pressure-temperature rating and corrosion resistance equal to or exceeding those of the main valve.

Bypasses are attached at the side of the main valve with the stems of both valves parallel, pointing vertically upwards as shown below.

When other bypass configurations are required, a sketch or drawing must accompany the order

• By-pass Connection

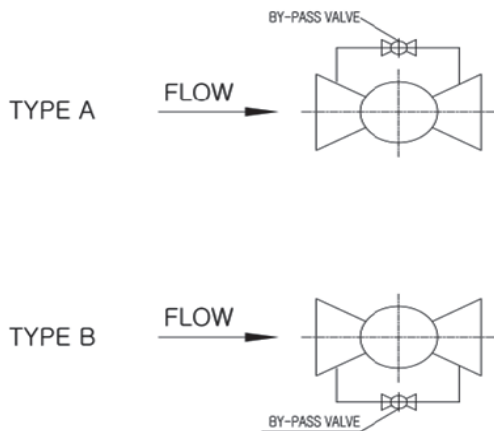

• By-pass Locations

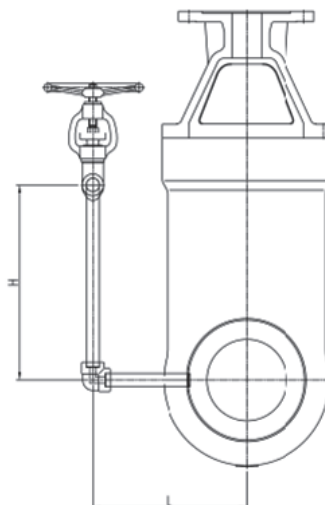
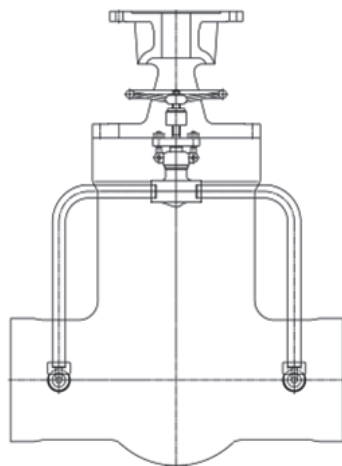
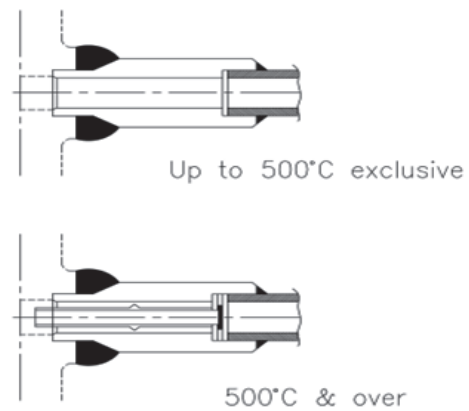

API 602 TRIM NUMBER CHART



Trim Number (CN)	"Nominal Trim"	Seat Surface Hardness(HB) Minimum	Seat Surface Material Type	Seat Surface Typical Specification Grade			Stem		
				Cast	Forged	Welded	"Material Type"	Typical Specifications Type	"Stem Hardness (HB)"
3	F310	Manufacturer's STD Hardness	25Cr-20Ni	N/A	A182(F310)	AWS A5.9 ER310	25Cr-20Ni	A276-T310	Manufacturer's STD Hardness
4	Hard F6	750	Hard 13Cr	N/A	Nitriding	N/A	13Cr	A276-T410 or T420	200min 275max
5	Hardfaced	350	Co-Cr A	N/A	N/A	AWS A5.13 E or R CoCrA	13Cr	A276-T410 or T420	200min 275max
5A	Hardfaced	350	Ni-Cr	N/A	N/A	Manufacturer's STD Hardness	13Cr	A276-T410 or T420	200min 275max
6	F6 and Cu-Ni	250 175	13Cr and Cu-Ni	A217(CA 15) N/A	A182(F6a)	AWS A5.9 ER410 N/A	13Cr N/A	A276-T410 or T420 N/A	200min 275max N/A
7	F6 and Hard F6	250 750	13Cr and BODY MT'L or EQ+13Cr	A217(CA 15) N/A	A182(F6a)	AWS A5.9 ER410 N/A	13Cr N/A	A276-T410 or T420 N/A	200min 275max N/A
8	F6 and Hardfaced	250 350	13Cr and Co-Cr A	A217(CA 15) N/A	A182(F6a) N/A	AWS A5.9 ER410 AWS A5.13 E or R CoCrA	N/A	A276-T410 or T420 N/A	200min 275max N/A
8A	F6 and Hardfaced	250 350	13Cr and Ni-Cr	A217(CA 15) N/A	A182(F6a) N/A	AWS A5.9 ER410	13Cr N/A	A276-T410 or T420 N/A	200min 275max N/A
9	Monel	Manufacturer's STD Hardness	Ni-Cr Alloy	N/A	MGF Standard	N/A	Ni-Cr Alloy	MGF Standard	Manufacturer's STD Hardness
10	316	Manufacturer's STD Hardness	18Cr-8Ni	A351(CF8M)	A183(F316)	AWS A5.9 ER316	18Cr-8Ni-Mo	A276-T316	Manufacturer's STD Hardness
11	Monel and Hardfaced	Manufacturer's STD Hardness 350	Ni-Cr Alloy and Trim 5 or 5A	N/A	MGF Standard	N/A See Trim 5 or 5A	Ni-Cr Alloy N/A	MGF Standard N/A	Manufacturer's STD N/A
12	316 and Hardfaced	Manufacturer's STD Hardness 350	18Cr-8Ni-Mo Trim 5 or 5A	N/A	MGF Standard	AWS A5.9 ER316 See Trim 5 or 5A	18Cr-8Ni-Mo N/A	A276-T316 N/A	Manufacturer's STD Hardness N/A
13	Alloy 20	Manufacturer's STD Hardness	19Cr-29Ni	A351 (CN7M)	B473	AWS A5.9 ER320	19Cr-29Ni	B473	Manufacturer's STD N/A
14	Alloy 20 and Hardfaced	Manufacturer's STD Hardness 350	19Cr-29Ni and Trim 5 or 5A	A351 (CN7M) N/A	B473 N/A	AWS A5.9 ER320 See Trim 5 or 5A	19Cr-29Ni N/A	B473 N/A	Manufacturer's STD N/A
15	Hardfaced	350	Co-Cr A	N/A	N/A	AWS A5.13 ECoCr-A	18Cr-8Ni	A276-T304	Manufacturer's STD Hardness
16	Hardfaced	350	Co-Cr A	N/A	N/A	AWS A5.13 ECoCr-A	18Cr-8Ni-Mo	A276-T316	Manufacturer's STD Hardness
17	Hardfaced	350	Co-Cr A	N/A	N/A	AWS A5.13 ECoCr-A	18Cr-10Ni-Cb	A276-T347	Manufacturer's STD Hardness
18	Hardfaced	350	Co-Cr A	N/A	N/A	AWS A5.13 ECoCr-A	19Cr-29Ni	B473	Manufacturer's STD Hardness
19	Nickel	Manufacturer's STD Hardness	Ni Alloy	MGF Standard	MGF Standard	-	Ni Alloy	MGF Standard	Manufacturer's STD Hardness
20	Nickel and Hardfaced	Manufacturer's STD Hardness	Ni Alloy	MGF Standard	MGF Standard	-			Manufacturer's STD Hardness
		350	Co-Cr A	-	-	AWS A5.13 ECoCr-A AWS A5.21 ERCoCr-A	-	-	Manufacturer's STD Hardness
21	Hardfaced	350	Co-Cr A	-	-	AWS A5.13 ECoCr-A AWS A5.21 ERCoCr-A	Ni Alloy	MGF Standard	Manufacturer's STD Hardness

Materials for Valve Parts Other than Trim Items	
Part	Material
Body and Bonnet(a, b, c)	A forging, forged bar or casting material as selected from ASME B16.34, Group 1, 2 or Group 3 and listed in Table 1.
Cover plate (a, b, c)	A forging, forged bar or casting material as selected from ASME B16.34, Group 1,2 or Group 3 and listed in Table 1 may also be used. Plate material listed in ASME B16.34, Table 1 may also be used for check valve covers.
Bonnet extension and union nut(c)	A material of the same nominal composition as the bonnet as selected from the list of material from which the body was selected.
Bellows	See B.6
Bellows fittings	Attachment rings and other bellows fittings shall be of materials suitable for attachment welding of the bellows to the valve body, bonnet or stem as applicable.
Wedge/disc	The base material of the wedge/disc shall be of a nominal material composition equal to the body material or the stem material (see 6.1.4)
Yoke, separate	Carbon steel, stainless steel or similar material composition as the bonnet.
Bolting : body-to-body and body-to-cover	Unless other materials are agreed between the purchaser and manufacturer, refer to the recommended bolting material in Annex G.
Bolting : gland and yoke	Bolting materials of a Type 300 or Type 400 series stainless steel. Also, material at least equal to ASTM A307-Grade B may be used for yoke bolting.
Seat ring	The base material of the seat ring, when used, shall be of a nominal material composition wqual to the body material or the stem material(see 6.1.4)
Gland flange	Steel.
Packing nut	To be of a material with a corrosion resistance at least equal to the body.
Gland	Material with a melting point above 1750°F (995°C)
Packing	Non-asbestos material suitable for steam and petroleum fluids over a temperature range of -29°C to 540°C (-20°F to 1000°F) and containing a corrosion inhibitor.
Gaskets	See 5.5.3
Stem nut or stem bushing	Austenitic ductile iron, 13Cr Steel, or copper alloy having a melting point above 955°C (1750°F)
Misc. internal parts (i.e. spring, hinge pin, disc nut)	Similar material composition as would be used for a valve stem, based on the valve trim requirement.
handwheel	Malleable iron, carbon steel, or ductile iron.
Identification plate	A corrosion resistant metal.

- a A preference for body and bonnet or cover material from (e.g. forging, forged bar, or casting) requires specification by the purchaser (see Annex F)
- b For valve sizes $DN \leq 50$ ($NPS \leq 2$), the reference standard design specifies forging material for the body and bonnet, or cover (see 5.1)
- c Bonnet nuts, welded, and threaded and seal welded bonnets, and bonnets of ISRS valves may be made from bar stock. The bar stock shall be listed and meet the requirements of Table 1, Group 1, Group 2, and Group 3 of ASME B16.34, including the notes, for the appropriate material group. Free machining material shall not be used.



SVT Beyond the valves
CORPORATION

HEAD OFFICE & PLANT 1: 40, HWANGGEUM-RO, 273 BEON-GIL, YANGCHON-EUP,
GIMPO-SI, GYEONGGI-DO, KOREA

PLANT 2: 68, HWANGGEUM-RO, 291 BEON-GIL, YANGCHON-EUP, GIMPO-SI,
GYEONGGI-DO, KOREA

CONTACT: +82. 31. 8049. 8911

FAX: +82. 31. 8049. 8910

E-MAIL: SALES@SVTCORP.CO.KR

WEBSITE: WWW.SVTCORP.CO.KR